

BLOSSBURG BOROUGH

THE BUILDING REGULATORY PROCESS

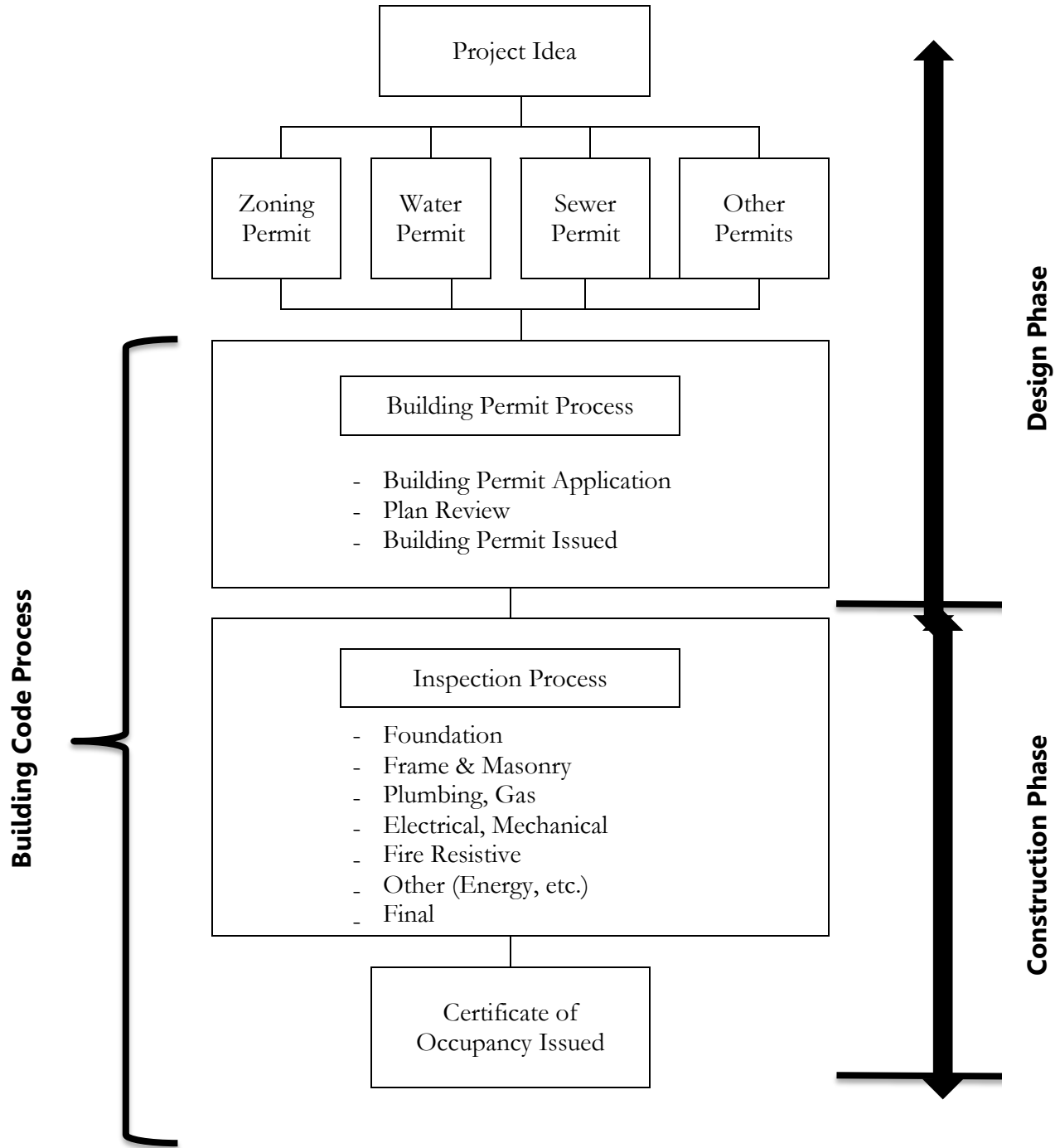

**BLOSSBURG BOROUGH
BUILDING CODE OFFICE**
241 MAIN STREET
BLOSSBURG, TIOGA COUNTY, PENNSYLVANIA
16912

NEW HOURS FOR BLOSSBURG BOROUGH BUILDING PERMITS:

BUILDING PERMIT APPLICATIONS CAN BE PICKED UP AT THE BOROUGH OFFICE MONDAY THROUGH FRIDAY, 9:00 A.M. TO 5:00 P.M.

PERMITS ARE NOT ISSUED AT THE TIME YOU GET THE APPLICATION. COMPLETED APPLICATIONS WILL BE REVIEWED TUESDAY AND THURSDAY, BY APPOINTMENT ONLY, BETWEEN THE HOURS OF 3:30 PM TO 5:00 PM.

RESIDENTIAL PERMITS - THE BUILDING CODE OFFICIAL SHALL GRANT OR DENY A PERMIT APPLICATION, IN WHOLE OR PART, WITHIN **5 BUSINESS DAYS** OF FILING DATE OR THE APPLICATION IS DEEMED APPROVED.

COMMERCIAL PERMITS - THE BUILDING CODE OFFICIAL SHALL GRANT OR DENY A PERMIT APPLICATION, IN WHOLE OR PART, WITHIN **30 BUSINESS DAYS** OF THE FILING DATE.

PLAN YOUR PROJECTS ACCORDINGLY.

Michael R. Stoudt

Uniform Construction Code Inspection Service	Blossburg Borough Building	Phone: (570) 638-5500
	241 Main Street	Cell: (570) 244-8749
	Blossburg, PA 16912	Fax: (570) 638-5507
	Email: mstoudt@ptd.net	

COST PER SQUARE FOOT

USE GROUP		TYPE OF CONSTRUCTION								
		IA	IB	IIA	IIB	IIIA	IIIB	IV	VA	VB
A-1	ASSEMBLY, THEATERS, WITH STAGE	0.80	.077	0.75	0.72	0.68	0.66	0.70	0.62	0.60
	ASSEMBLY, THEATERS, WITHOUT STAGE	0.72	0.70	0.68	0.65	0.60	0.58	0.62	0.55	0.52
A-2	ASSEMBLY, NIGHTCLUBS	0.61	0.59	0.58	0.55	0.52	0.51	0.54	0.47	0.46
A-2	ASSEMBLY, RESTAURANT, BARS, BANQUET HALLS	0.61	0.59	0.57	0.55	0.51	0.50	0.53	0.47	0.45
A-3	ASSEMBLY, CHURCHES	0.73	0.71	0.69	0.66	0.62	0.60	0.64	0.56	0.53
A-3	ASSEMBLY, GENERAL, COMMUNITY HALLS, LIB, MUSEUM	0.62	0.60	0.57	0.55	0.50	0.48	0.52	0.44	0.42
A-4	ASSEMBLY, ARENAS	0.72	0.69	0.67	0.64	0.60	0.58	0.62	0.54	0.52
B	BUSINESS	0.62	0.59	0.58	0.55	0.50	0.48	0.53	0.44	0.42
E	EDUCATIONAL	0.68	0.65	0.64	0.61	0.57	0.54	0.59	0.50	0.48
F-1	FACTORY AND INDUSTRIAL, MODERATE HAZARD	0.37	0.36	0.34	0.33	0.29	0.28	0.31	0.24	0.23
F-2	FACTORY AND INDUSTRIAL, LOW HAZARD	0.37	0.35	0.34	0.32	0.29	0.27	0.31	0.24	0.22
H-1	HIGH HAZARD, EXPLOSIVES	0.35	0.33	0.32	0.32	0.27	0.26	0.29	0.22	NP
H-2 TO H-4	HIGH HAZARD	0.35	0.33	0.32	0.30	0.27	0.26	0.29	0.22	0.20
H-5	HPM	0.62	0.59	0.58	0.55	0.50	0.48	0.53	0.44	0.42
I-1	INSTITUTIONAL, SUPERVISED ENVIRONMENT	0.62	0.60	0.58	0.56	0.52	0.51	0.56	0.47	0.45
I-2	INSTITUTIONAL, INCAPACITATED	1.04	1.02	1.00	0.97	0.92	NP	0.95	0.86	NP
I-3	INSTITUTIONAL, RESTRAINED	0.71	0.69	0.67	0.64	0.60	0.57	0.62	0.53	0.51
I-4	INSTITUTIONAL, DAY CARE FACILITIES	0.62	0.60	0.58	0.56	0.52	0.51	0.56	0.47	0.45
M	MERCANTILE	0.45	0.44	0.42	0.40	0.36	0.35	0.38	0.32	0.30
R-1	RESIDENTIAL, HOTELS	0.63	0.61	0.59	0.57	0.53	0.51	0.57	0.50	0.46
R-2	RESIDENTIAL, MULTIPLE FAMILY	0.53	0.50	0.49	0.46	0.43	0.41	0.47	0.38	0.36
R-3 & IRC*	RESIDENTIAL, ONE AND TWO FAMILY	0.50	0.48	0.47	0.54	0.44	0.43	0.45	0.41	0.36
R-4	RESIDENTIAL, CARE/ASSISTED LIVING FACILITIES	0.62	0.60	0.58	0.56	0.52	0.51	0.56	0.47	0.45
S-1	STORAGE, MODERATE HAZARD	0.35	0.33	0.31	0.30	0.26	0.25	0.28	0.21	0.20
S-2	STORAGE, LOW HAZARD	0.34	0.33	0.31	0.29	0.26	0.25	0.28	0.21	0.20
U	UTILITY, MISC.	0.26	0.25	0.24	0.22	0.20	0.19	0.21	0.16	0.15
	R-3 Garages	0.26								
	Unfinished basements (all use groups)	0.12								
	Finished basements (all use groups)	.024								
	NP Not permitted									

ELECTRICAL FEES

Rough Wiring or Final Inspection
1 to 25 Outlets - \$50.00 (Minimum \$70.00/Trip)
For each additional 10 or fraction thereof - \$10.00

Motors, Appliances and other Equipment
¼ HP, KW or KVA to 3 HP, KW, or KVA each - \$25.00
4 HP, KW or KVA to 7 HP, KW or KVA each - \$35.00
7½ HP, KW or KVA to 29 HP, KW or KVA each - \$40.00
30 HP, KW or KVA to 49 HP, KW or KVA each - \$50.00
50 HP, KW, or KVA to 74 HP, KW or KVA each - \$60.00
75 HP, KW or KVA to 199 HP, KW or KVA each - \$125.00
200 HP, KW or KVA to 500 HP, KW or KVA each - \$250.00
Over 500 HP, KW or KVA each - \$300.00

Feeders or Sub-Panels
Not over 225 Amp - \$35.00
Over 225A to 400A - \$50.00
Over 400A to 600A - \$60.00
Over 600A to 1200A - \$75.00
Over 1200A - \$100.00
(Over 600 Volts – add \$50.00 per category)

Service Equipment
Not over 200A - \$80.00
Over 200A to 400A - \$100.00
Over 400A to 600A - \$150.00
Over 600A to 1200A - \$250.00
Over 1200A - \$300.00

(GFI Protected Service add \$50.00. Over 600 Volts add \$100.00)

Dwellings, Multiple Services and all other Equipment – Apply for Fee

PLOT PLAN

1. This page shall be used for the drawing of a site plan for all major construction and in such other cases as the Building Inspector deems necessary,
2. The site plan shall show the location and size of the lot, locations and sizes of the buildings and structures upon the premises (both existing and proposed and their relationship to adjoining premises and public roads.
3. Locate and label clearly and distinctly all buildings and structures, show widths and depths of all yards, show names of all roads and indicate north with a north arrow.
4. If the principal building or structure is to be served by an on-site sewage disposal system a sketch of the system shall be shown.
5. Show location and layout of off-street parking and/or loading and report number of spaces.
6. Attach a location map.

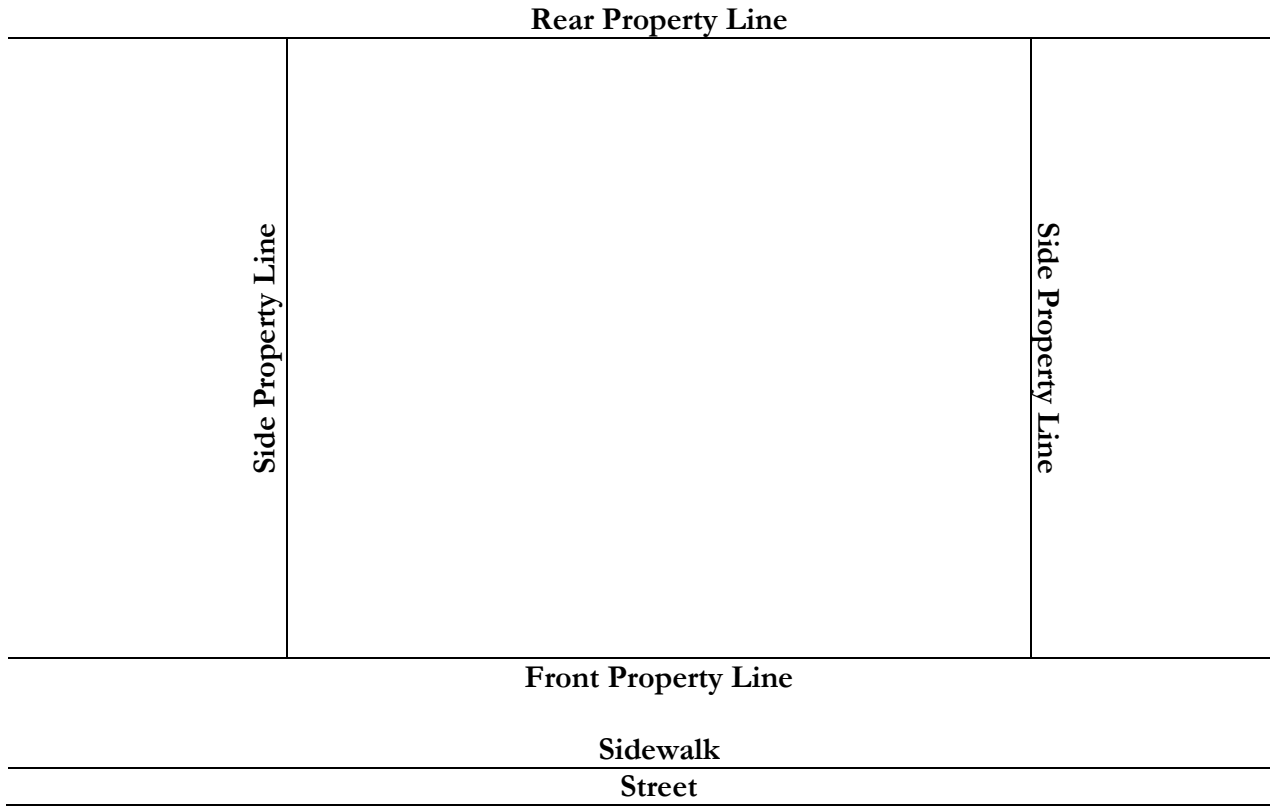

Locate all structures with a solid line.
 Locate proposed structures with a broken line.

DESCRIPTION _____

Zone District _____ Date _____

BLOSSBURG BOROUGH
241 MAIN STREET
BLOSSBURG, TIOGA COUNTY, PENNSYLVANIA
16912
(570) 638-5500
FAX: (570) 638-5507

HOMEOWNER'S WORKERS' COMPENSATION AFFIDAVIT

I, _____ do solemnly swear that I will not employ/hire any other persons for the project for which I am seeking a building permit.

After receipt of the building permit if I employ any other persons I must notify the Borough Office and provide proof of workers' compensation coverage within three (3) working days.

I understand that failure to comply will result in a stop-work order and that such may not be lifted until proper coverage is obtained, as provided by Section 302 (e) (4) of the Act of June 2, 1915 (P.L. 736), known as the Workmen's Compensation Act, reenacted and amended June 21, 1939 and amended December 5, 1974 and amended July 2, 1993. (Act 44).

Signature of Applicant

SUBSCRIBED AND SWORN BEFORE ME THIS _____ DAY OF _____ 20_____.

Signature of Notary
Notary Seal:

PERMIT APPLICATION

(FOR CODE ADMINISTRATOR USE ONLY)

APPROVALS

BUILDING PERMIT DENIED: Date _____		Date Returned _____
BUILDING PERMIT APPROVED: Date _____		
CODE ADMINISTRATOR _____		
Date Issued _____	Date Expires _____	PERMIT # _____
BUILDING PERMIT FEE \$ _____	RECEIPT # _____	
PLUMBING PERMIT (if appl.) \$ _____	RECEIPT # _____	
MECHANICAL PERMIT (if appl.) \$ _____	RECEIPT # _____	
ELECTRICAL PERMIT (if appl.) \$ _____	RECEIPT # _____	

PROJECT DOCUMENTS (DRAWINGS & CALCULATIONS)

<u>Type of document:</u> <u>Date:</u>	<u>Submitted</u> <u>Revision Date:</u>				<u>Signed & Sealed</u>			
Foundation Plans	<input type="checkbox"/>	YES	<input type="checkbox"/>	NO	<input type="checkbox"/>	YES	<input type="checkbox"/>	NO
Construction Drawings	<input type="checkbox"/>	YES	<input type="checkbox"/>	NO	<input type="checkbox"/>	YES	<input type="checkbox"/>	NO
Electrical Drawings	<input type="checkbox"/>	YES	<input type="checkbox"/>	NO	<input type="checkbox"/>	YES	<input type="checkbox"/>	NO
Mechanical Drawings	<input type="checkbox"/>	YES	<input type="checkbox"/>	NO	<input type="checkbox"/>	YES	<input type="checkbox"/>	NO
Plumbing Drawings	<input type="checkbox"/>	YES	<input type="checkbox"/>	NO	<input type="checkbox"/>	YES	<input type="checkbox"/>	NO
Specifications	<input type="checkbox"/>	YES	<input type="checkbox"/>	NO	<input type="checkbox"/>	YES	<input type="checkbox"/>	NO
Flood Hazard Area Data	<input type="checkbox"/>	YES	<input type="checkbox"/>	NO	<input type="checkbox"/>	YES	<input type="checkbox"/>	NO
Workers Comp. Certificate	<input type="checkbox"/>	YES	<input type="checkbox"/>	NO	<input type="checkbox"/>	YES	<input type="checkbox"/>	NO

DATE STAMP:

BLOSSBURG BOROUGH
241 MAIN STREET
BLOSSBURG, TIOGA COUNTY, PENNSYLVANIA
16912
(570) 638-5500
FAX: (570) 638-5507

**RESIDENTIAL BUILDING PERMIT
INSPECTION SHEET**

INSPECTIONS NOTED ON THIS CARD MAY BE SCHEDULED BY TELEPHONE WITH A 24-HOUR NOTIFICATION. WORK SHALL NOT PROCEED UNTIL THE FIELD INSPECTION HAS BEEN APPROVED.

SUPERIOR WALL SYSTEM –

FOOTING: Prior to installing stone bed & setting walls.

FOUNDATION: After 1st floor and deck are set, prior to backfilling.

CONCRETE/MASONRY SYSTEM –

FOOTINGS: Prior to pouring concrete.

FOUNDATION: Prior to backfilling.

ABOVEGROUND PLUMBING: Prior to covering, drainage & water line test required.

ELECTRICAL ROUGH-IN: Prior to covering, all wiring & boxes shall be installed. All grounds shall be made for this inspection.

MECHANICAL ROUGH-IN: Prior to covering. Gas piping test is required.

FRAMING: Prior to insulation or covering.

ELECTRICAL FINAL: All equipment, fixtures & devices shall be functional.

MECHANICAL FINAL: All equipment shall be set & functional.

PLUMBING FINAL: All equipment & fixtures shall be set & functional.

FINAL: Prior to any use or occupancy.

PERMIT HOLDER: _____

ADDRESS: _____

PERMIT NUMBER: _____ DATE: _____

This permit is valid for one year and construction shall commence within six (6) months of Permit issuance. Application for Certificate of Use and Occupancy must be filled out and Returned prior to the final inspection approval.

BLOSSBURG BOROUGH
241 MAIN STREET
BLOSSBURG, TIOGA COUNTY, PENNSYLVANIA
16912
(570) 638-5500
FAX: (570) 638-5507

Submittal Guide for Commercial Projects

Building Plan Requirements for Commercial Projects

The following items are required for new commercial projects. Drawings should be drawn to 1/4" or 1/8" scale and shall provide the necessary information to verify compliance with the building code. **All drawings shall bear the stamp and signature of the design professional responsible for the design.**

Two (2) sets of construction drawings shall be submitted and shall include:

Title Page Drawing; to include the contact information for all design professionals, description of square footage per floor, number of floors, type of construction to be utilized, area modifications utilized, use group classification(s), separation or non-separation of mixed use groups, design occupant load(s), finish materials classification, design codes utilized.

Site Plan Drawings; to include all utility layouts, handicap parking & access, designated fire lanes, distance between adjacent structures and property lines.

Floor Plan Drawings; to include the use of all areas, location & types of fire resistant construction, U.L. Listing of fire resistant construction, means of egress components, handicap access.

Structural Drawings; to include the structural design calculations, geo-technical engineering report, uniform live loads, dead loads, roof & snow loads, wind loads, footing construction detail, foundation construction details, framing construction details, concrete construction details, masonry construction details, steel construction details.

Electrical Drawings; to include all lighting facilities, electrically operated equipment, and electrical circuits required for all service equipment of the building or structure. Drawings should include panel schedules, grounding systems, and wiring methods.

Mechanical Drawings; to include size & type of appliances, construction of flues and chimney systems, ventilation air provided, fresh air make-up provided, location of all ducting and piping.

Plumbing Drawings; to include a plan view and a riser diagram of waste & water piping, pipe sizing, grade of piping, drainage fixture unit loads on stacks and drains, water distribution design criteria.

Fire Protection Systems; to include the submittal guide for each type of system. See specific submittal guide requirements.